

**Legend**

- Lot boundaries
- Parkland
- Railway precinct
- Railway line
- Overhead powerlines
- Existing kerb
- Existing kerb to be removed
- Proposed kerb
- Existing paved footpath
- Proposed concrete footpath
- Proposed paved footpath
- Proposed car park
- Existing fence
- Proposed fence
- Proposed shelter
- Proposed street furniture

**Tree & Plant Legend**  
(refer Plant Species Options list)

- Existing deciduous tree
- Existing evergreen tree
- Existing Eucalyptus tree
- Existing tree to be removed
- Existing shrub
- Proposed Plane tree
- Proposed large Eucalyptus tree
- Proposed medium deciduous tree
- Proposed small deciduous tree
- Proposed tree at pedestrian crossing
- Proposed garden bed
- Proposed tree cell

**Shepparton Railway Precinct Master Plan 2017**

- Railway station - with future upgrade
- Future mixed use development
- Future pedestrian overpass with lifts
- Future public realm space
- Future green space
- Future car park

Proposed traffic island to improve first impressions from Train station and provide improved pedestrian safety



Project: 1820\_Shepparton Railway Linkages  
 Sheet: LP05\_North Street Concept Plan  
 Client: Greater Shepparton City Council  
 Scale: 1:500 at A1 | Designed by: CR & GC | June 2018  
 Revision: | Drawn by: GC | June 2018  
 © Liesl Malan Landscape Architects | This Document is copyright protected and may only be used for the purpose for which it was commissioned. Unauthorised use prohibited. All dimensions and levels to be checked on the project before commencing any works or shop drawings. Drawings not to be scaled. | ABN 39 133 179 212



**High Street Streetscape Tree Options**  
Large deciduous or evergreen trees consistent along whole street



**Legend**

- Lot boundaries
- Parkland
- Railway precinct
- Railway line
- Overhead powerlines
- Existing kerb
- Proposed kerb
- Existing paved footpath
- Proposed concrete footpath
- Proposed paved footpath
- Proposed car park
- Existing fence
- Proposed fence
- Proposed shelter
- Proposed street furniture
- Proposed SSRIP Crossing
- Area of future development

**Tree & Plant Legend**  
(refer Plant Species Options list)

- Existing deciduous tree
- Existing evergreen tree
- Existing Eucalyptus tree
- Existing tree to be removed
- Proposed Plane tree
- Proposed large Eucalyptus tree
- Proposed medium deciduous tree
- Proposed small deciduous tree
- Proposed tree at pedestrian crossing
- Proposed garden bed
- Proposed tree cell

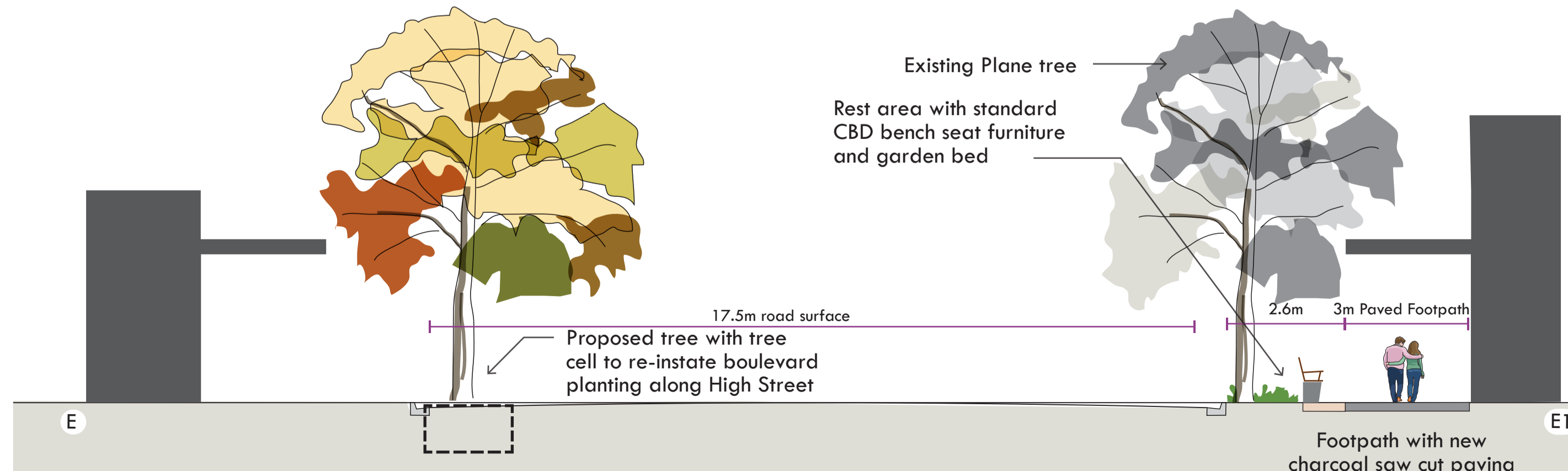
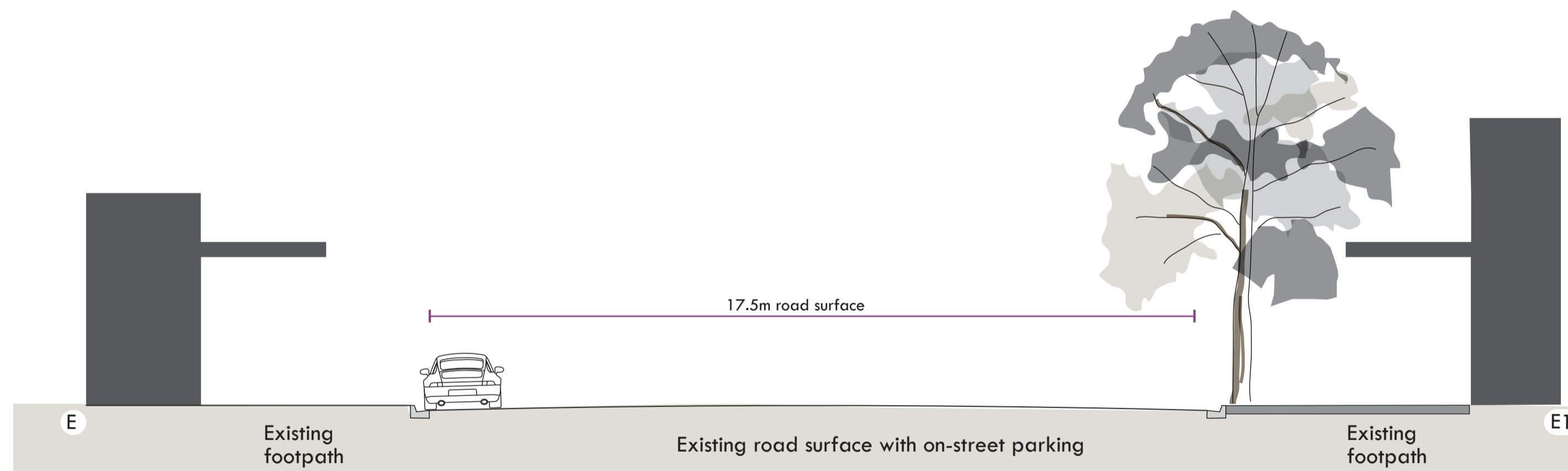

**Liesl Malan**  
LANDSCAPE ARCHITECTS

Project: 1820\_Shepparton Railway Linkages  
 Sheet: LP06\_High Street Concept Plan  
 Client: Greater Shepparton City Council

**HEC**  
HEIL  
ENGINEERING  
CONSULTANTS

Scale: 1:500 at A1 | Designed by: CR & GC | June 2018  
 Revision: | Drawn by: GC | June 2018  
 © Liesl Malan Landscape Architects | ABN 39 133 179 212  
 This Document is copyright protected and may only be used for the purpose for which it was commissioned. Unauthorised use prohibited. All dimensions and levels to be checked on the project before commencing any works or shop drawings. Drawings not to be scaled.

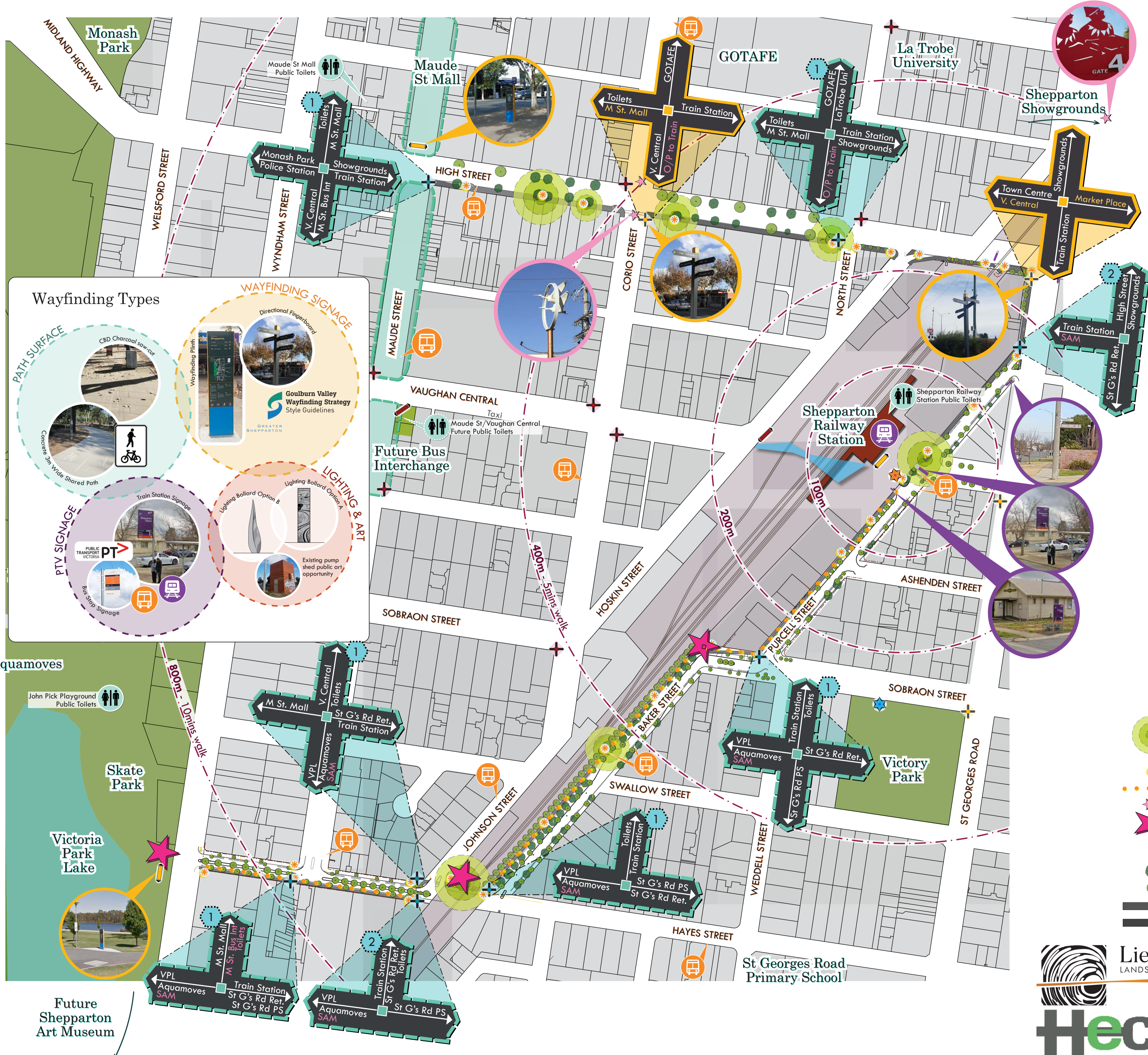

- ### Wayfinding Signage Legend
- Refer Goulburn Valley Wayfinding Strategy - Style Guidelines
- Existing wayfinding plinth location
  - Recommended future wayfinding plinth location
  - Existing directional fingerboard location
  - Proposed directional fingerboard location
  - Recommended directional fingerboard location (outside of project scope)
  - Proposed site identification sign
  - Recommended site identification sign (outside of project scope)
  - Existing Vline wayfinding signage (see photos)

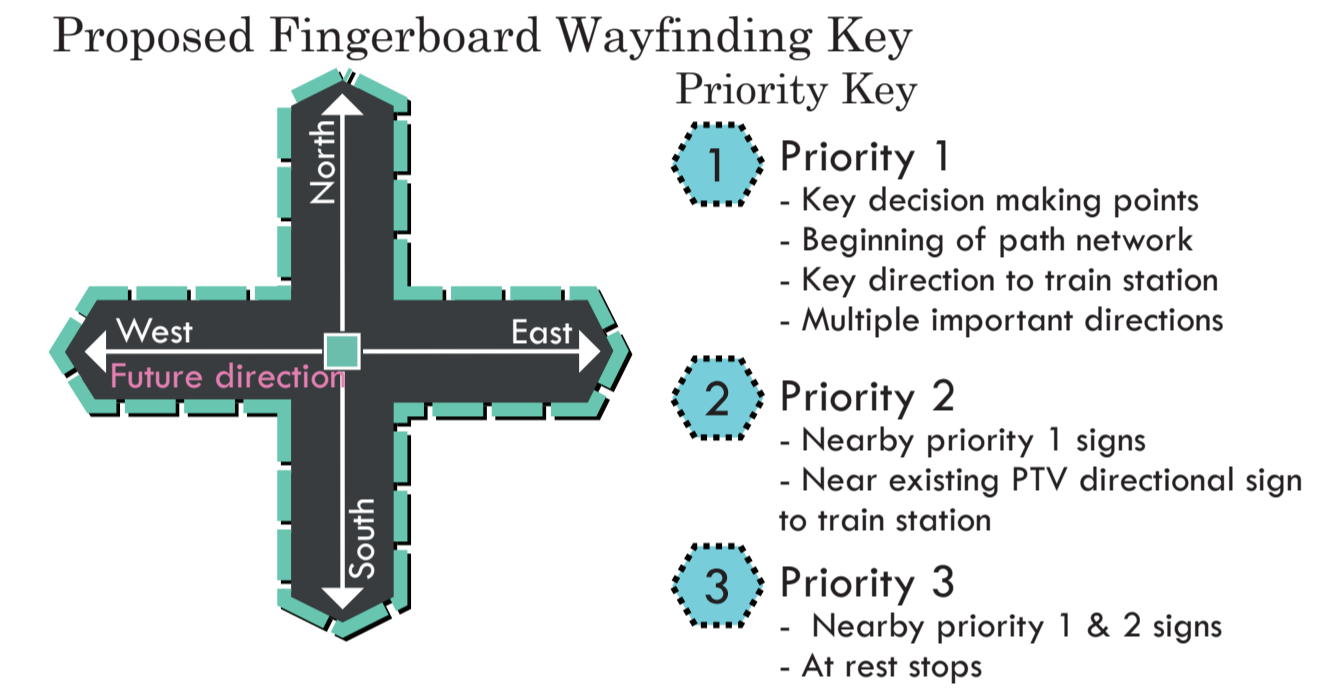
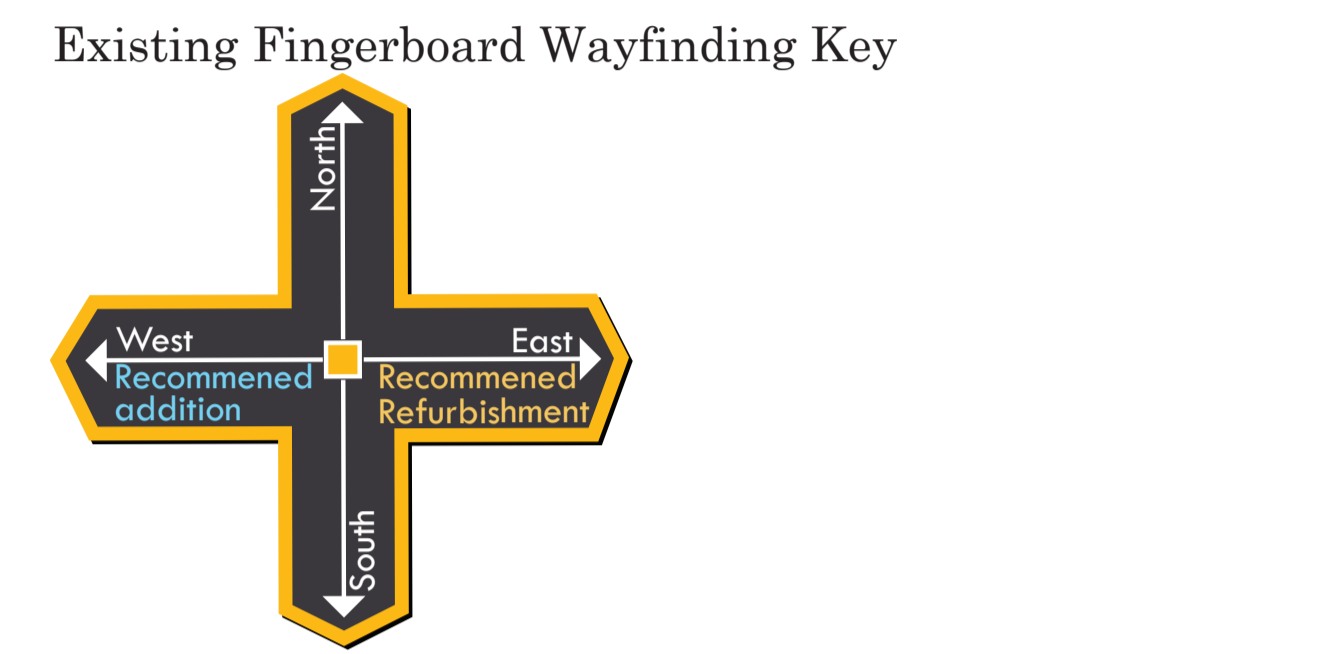

- ### Location Abbreviations
- SAM - Shepparton Art Museum
  - VPL - Victoria Park Lake
  - M St. Mall - Maude Street Mall
  - V. Central - Vaughan Central
  - M St. Bus Int - Maude St Bus Interchange
  - St G's Rd Ret. - St Georges Road retail area
  - St G's Rd PS - St Georges Road Primary School
  - O/P to Train - Train Station via Overpass

- ### Rest Stops, Lighting & Public Art Legend
- Proposed rest stop with seating
  - Existing Street light
  - Proposed pedestrian scale lighting
  - Proposed feature bollard lighting along shared path
  - Existing sculptural art/wayfinding
  - Proposed feature public art

- ### General Legend
- Existing tree
  - Proposed tree
  - Proposed concrete footpath
  - Proposed paved footpath

### Wayfinding Types

#### PATH SURFACE

- CBD Charcoal saw-cut
- Concrete 3m Wide Shared Path

#### WAYFINDING SIGNAGE

- Directional Fingerboard
- Wayfinding Plinth
- Goulburn Valley Wayfinding Strategy Style Guidelines

#### PTV SIGNAGE

- Train Station Signage
- Public Transport Victoria
- Bus Stop Signage

#### LIGHTING & ART

- Lighting Bollard Option A
- Lighting Bollard Option B
- Existing pump shed public art opportunity

### Aquamoves

John Pick Playground Public Toilets

### Skate Park

### Victoria Park Lake

800m - 10mins walk

Future Shepparton Art Museum

Feature Lighting Bollard Concept Sketch

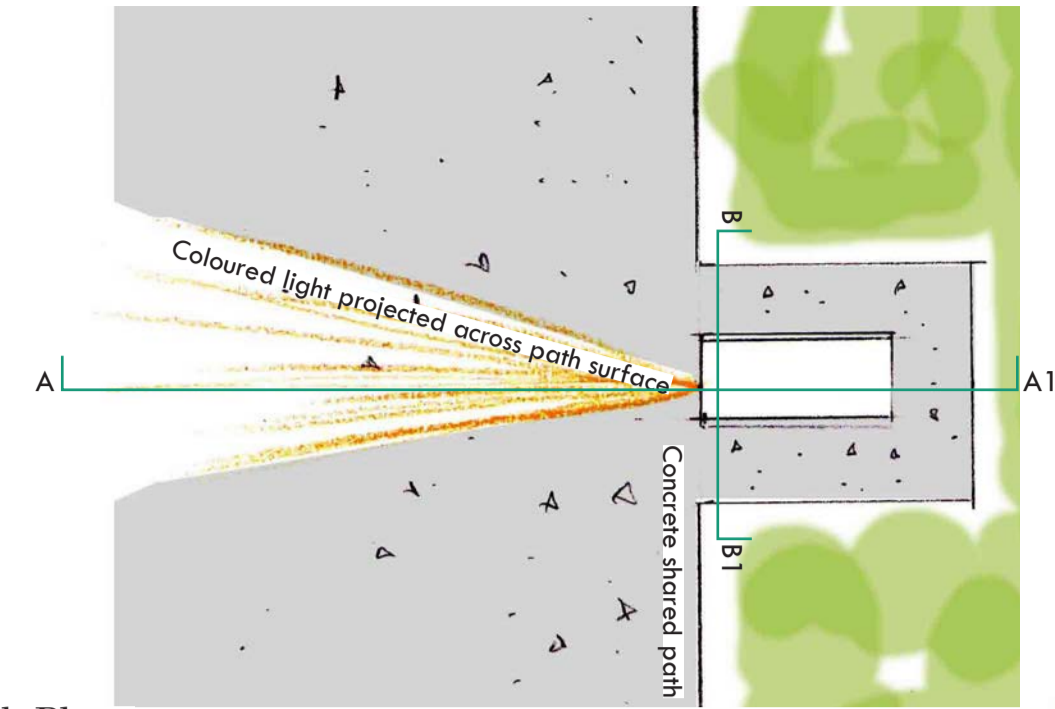

Concept Sketch Plan

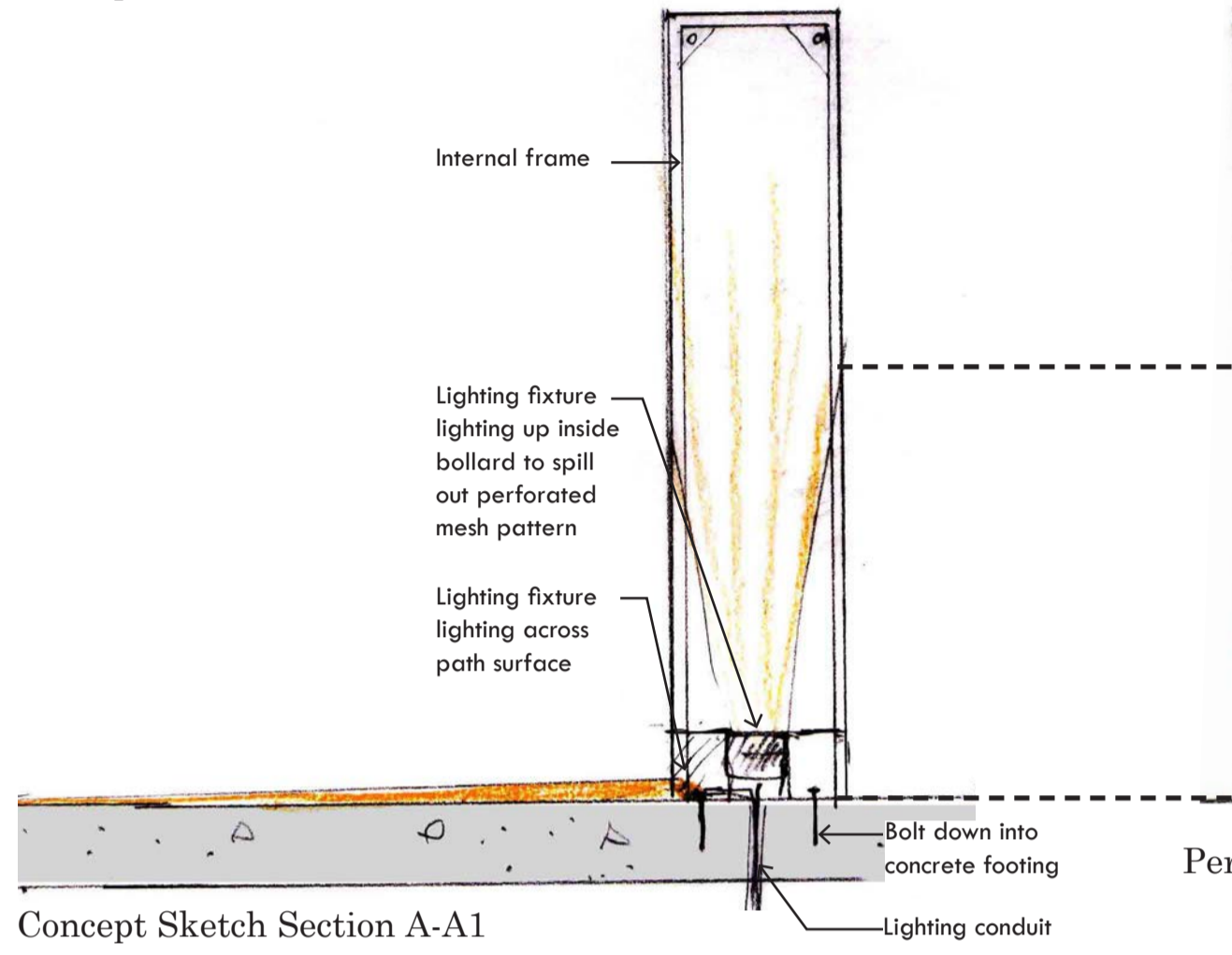

Concept Sketch Section A-A1

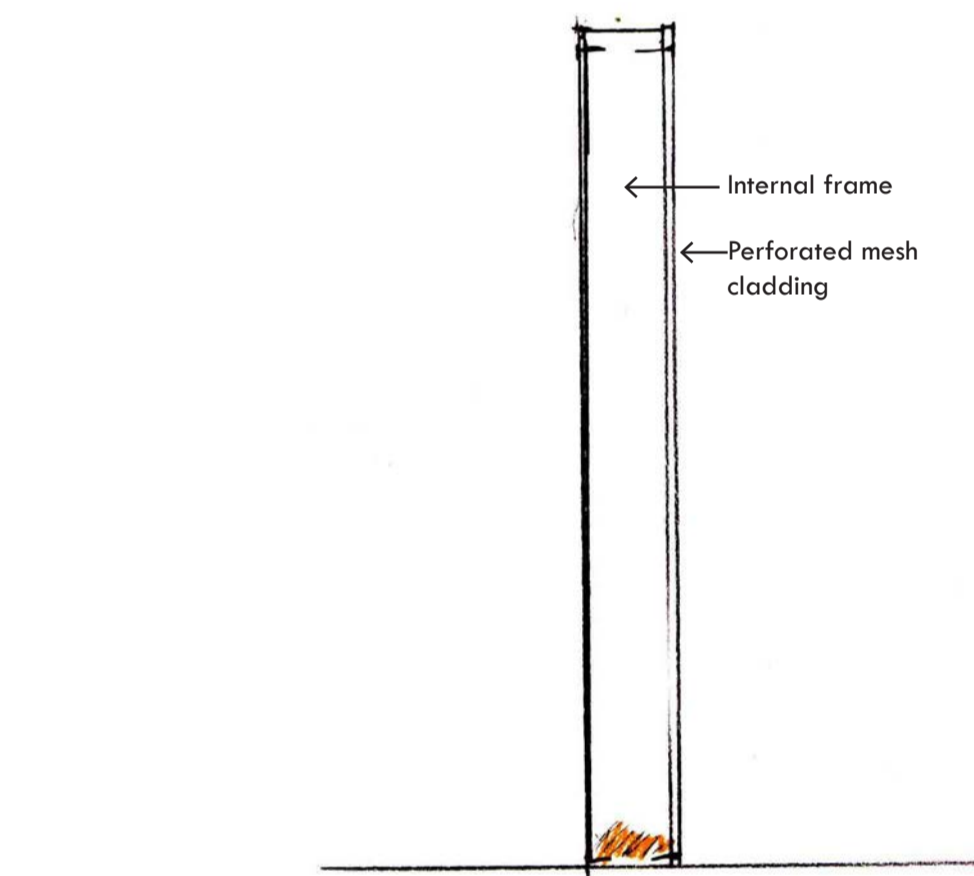

Concept Sketch Section B-B1

Feature Lighting Bollard Design Rationale

The feature bollards have been designed to welcome both tourists and locals. They link the Railway Station to the new Shepparton Art Museum (SAM) along a shared path. The artwork has been chosen to enhance the wayfinding experience for path users. The simple, robust design is easy to maintain and suits both the urban environment and the landscape context.

Materials & Maintenance

The structure includes a rectangular steel frame with perforated mesh cladding with laser-cut artwork. The frame design is simple to fabricate and the perforated panels will be easy to remove for maintaining the light fittings inside. The light fixtures chosen include all replaceable parts. Incorporating the light fixtures inside the frame and cladding will minimise the risk of vandalism. *Artwork*

The laser-cut design of the cladding provides an opportunity to feature a local artist from the Shepparton region. It could also be a collaborative design project with SAM. The design references the Victoria Park Lake environment as you travel the path to SAM. On the reverse side, the artwork could feature a train station themed design as you head towards the Station.

Lighting

When the lights are turned on, the artwork design will be lit from within and will help to guide pedestrians & cyclists to their destination. The light projected across the path surface will have a RGBW-DMX system allowing the colour of the light to change with simple software that can be accessed through a digital tablet or smartphone app. Colours can be altered for special events, community celebrations and commemorations. These could include: an opening event at SAM, St Patricks Day (green), SES day (orange) etc.

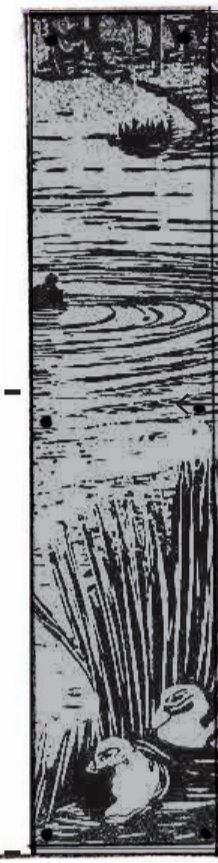

Perforated Mesh Pattern Concept

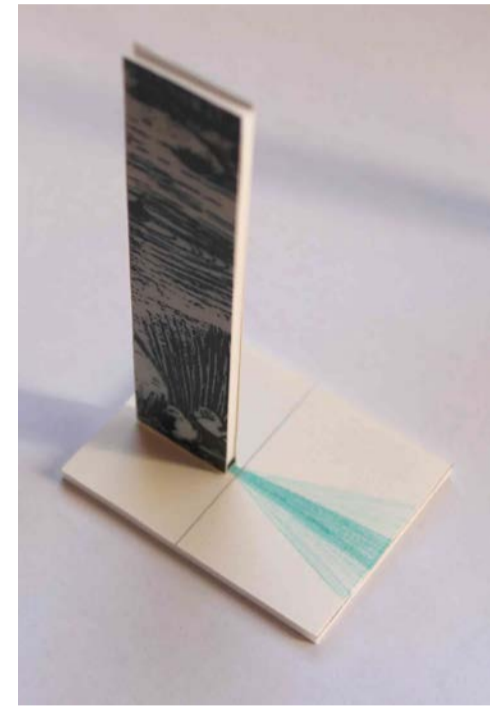

Coloured light projected across path surface



Lighting Fixtures

Uplighting fixture inside the bollard – Modux 2 luminaire  
Cross path lighting fixture – M4 RGBW – Square flange with 'wall washer eyelid' DMX signal controller

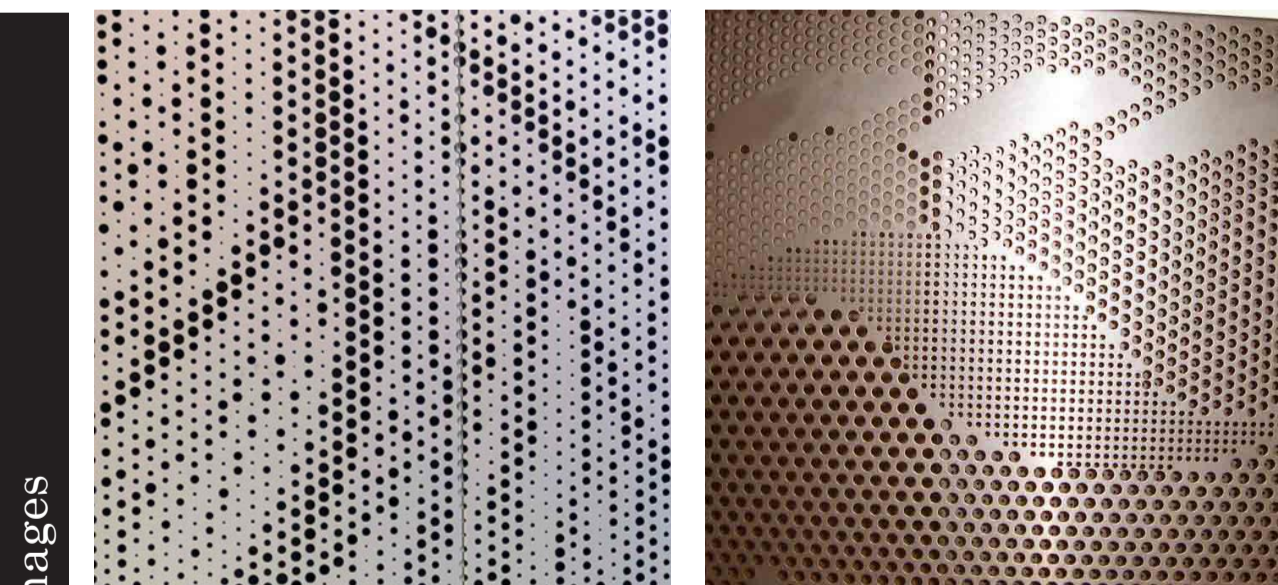

Pattern in perforated steel mesh



Lighting through perforated steel mesh

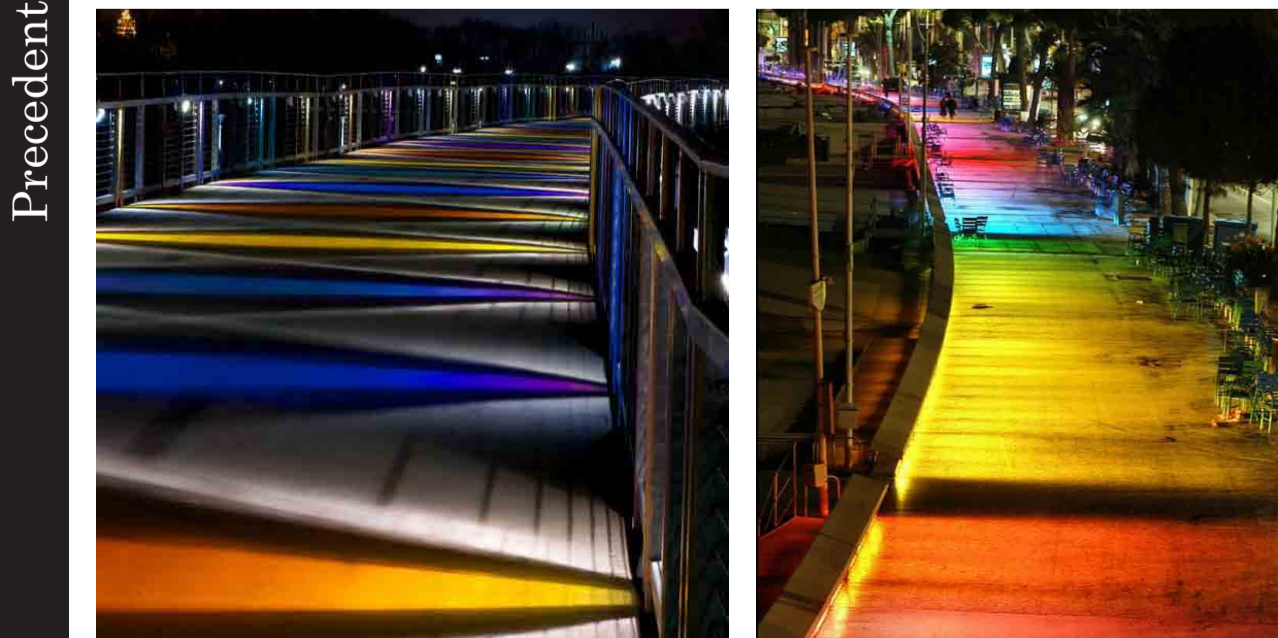

Lighting examples - images sourced from web



Feature lighting - Vaughan Street, Shepparton

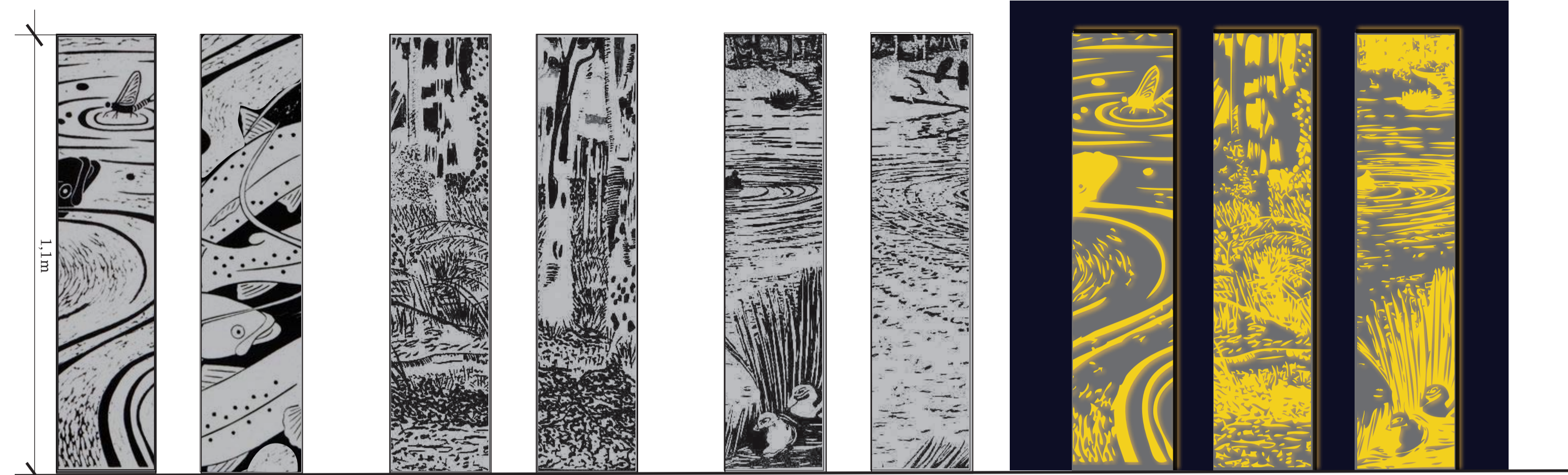

Option A 1 - Fish

Option A 2 - Bush

Option A 3 - Lake

Lighting example - internal light fittings



Artist : Donna Reed  
'Rising Trout'



Artist : Marie Mason  
'Early Evening Mooroopna Bush'



Artist : Marie Mason  
'Enjoying the Lake'

Please note :  
Illustrations are examples for discussion purposes only. Final artwork would be developed in collaboration with selected artist/s. All artwork would need to be robust enough for the public realm and easy to maintain. Safety issues, such as minimising finger entrapment, would need to be resolved and integrated into the final design.

Please note :  
Sketch Option only. Final design is subject to refinement and design development.



Lighting Art panels leading to Shepparton Railway Station

Artist : Maggie Stein 'Platform 6 Redfern Station'



Lighting - internal light fittings with perforated mesh



Lighting Art panels leading to SAM and Victoria Park Lake

Artist : Marie Mason 'Early Evening Mooroopna Bush'



Precedent Images



Project: 1820\_Shepparton Railway Linkages  
Sheet: LP08\_Lighting Concept Plan  
Client: Greater Shepparton City Council

Scale: 1:10 at A1 | Designed by: CR & GC | June 2018  
Revision: | Drawn by: GC | June 2018

© Liesl Malan Landscape Architects ABN 39 133 179 212  
This Document is copyright protected and may only be used for the purpose for which it was commissioned. Unauthorised use prohibited. All dimensions and levels to be checked on the project before commencing any works or shop drawings. Drawings not to be scaled.

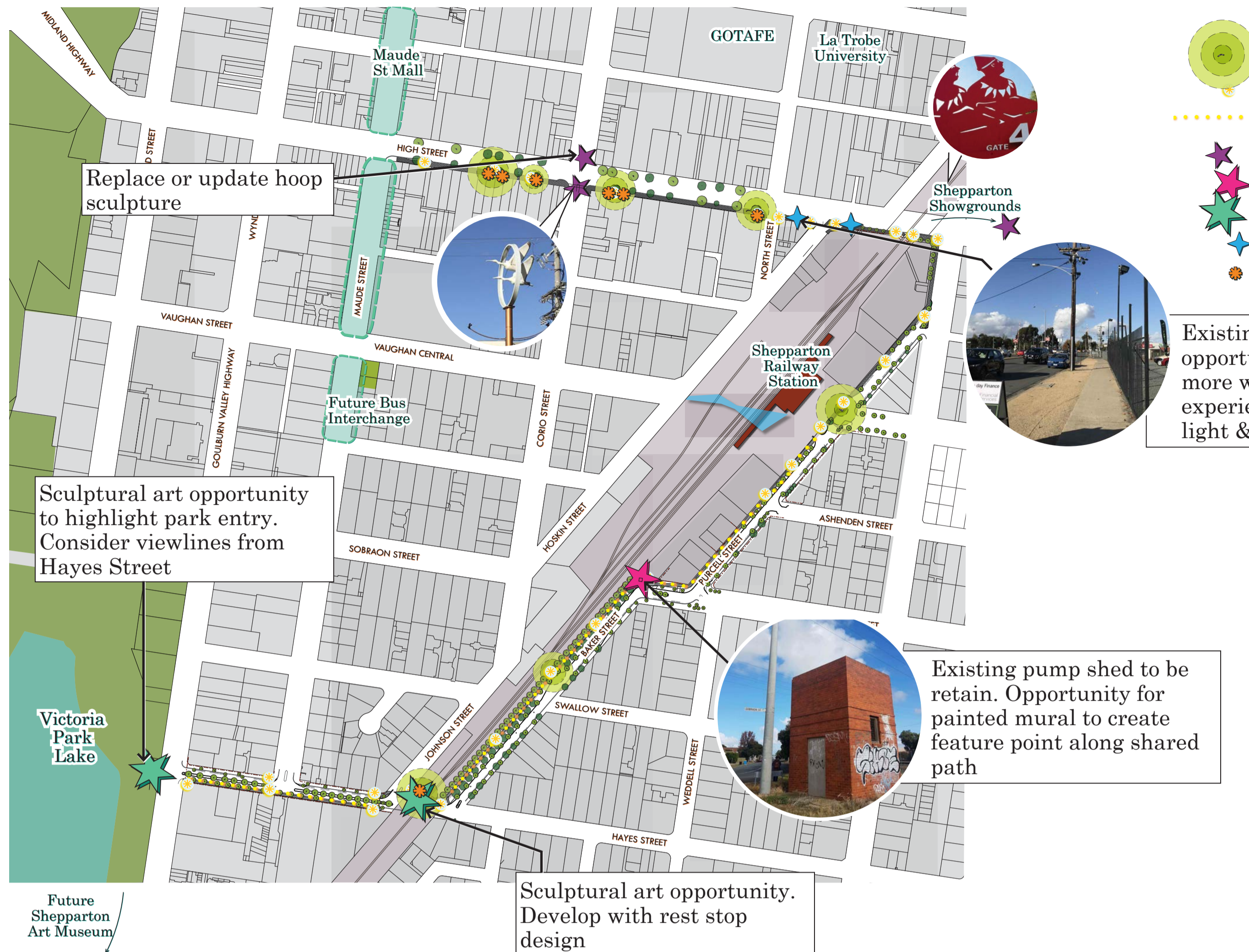

### Rest Stops, Lighting & Public Art Legend

- Proposed rest stop with seating
- Proposed pedestrian scale lighting
- Proposed feature bollard lighting along shared path
- Existing sculptural art/wayfinding
- Proposed feature public art - Mural Painting
- Proposed feature public art - Sculpture
- Proposed CBD bollard
- Proposed seating with feature panel artwork

Existing conditions, opportunity to create a more welcoming pedestrian experience by incorporating light & art elements



CBD seating - Vaughan Street, Shepparton



Feature CBD Bollards- Vaughan Street, Shepparton

Standard seating with pattern in base lighting  
 Incorporate different pattern in base with identity for High Street



Ardnate, Benalla Street Art

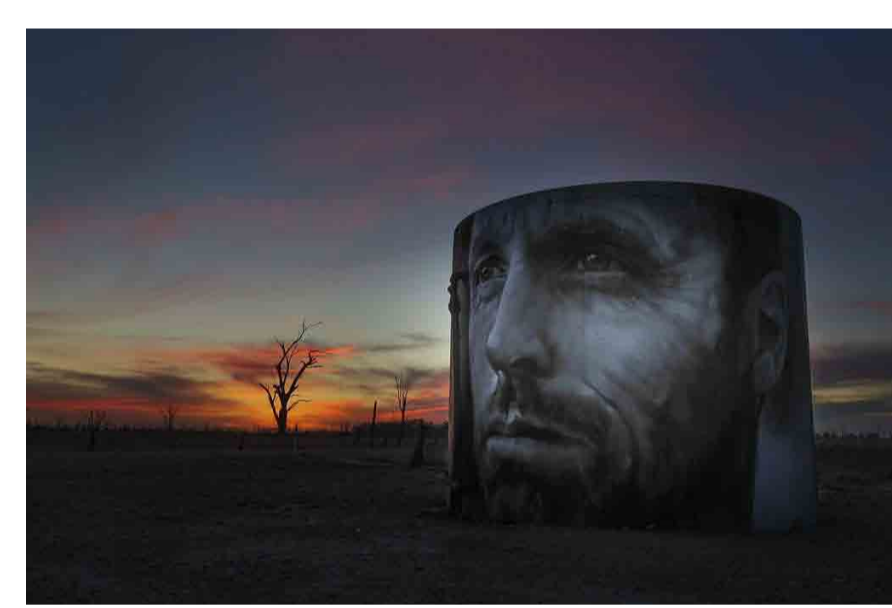

Guida Van Helten, Winton Wetlands



Sirum, Benalla Street Art



DZIA, Hanbury Street, London



Porto Sculpture, Ken Raff, Wodonga

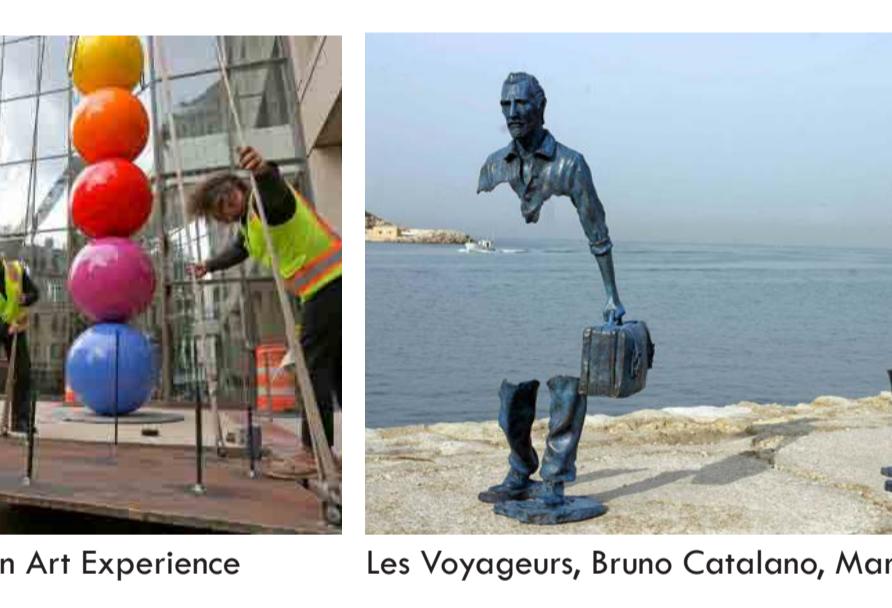

Sculpture Milwaukee, Urban Art Experience



Les Voyageurs, Bruno Catalano, Marseilles



Troy Pillow Sculpture, Seattle



Perth Street Art Festival 2015

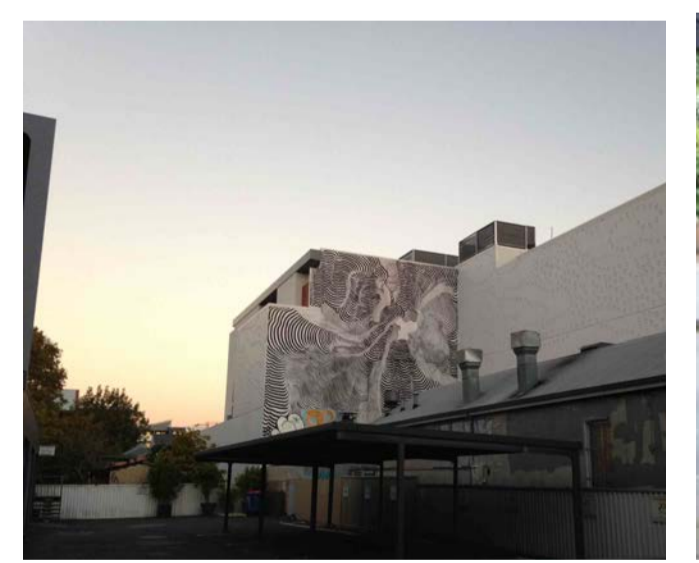

Fremantle Street Art



Portland Street Art Alliance



Perth Street Art



Anton Pulvirenti, Benalla



Dixon Patten



Dixon Patten

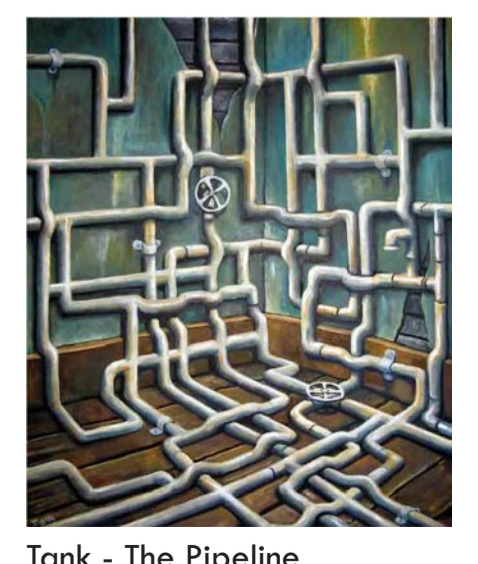

Tank - The Pipeline

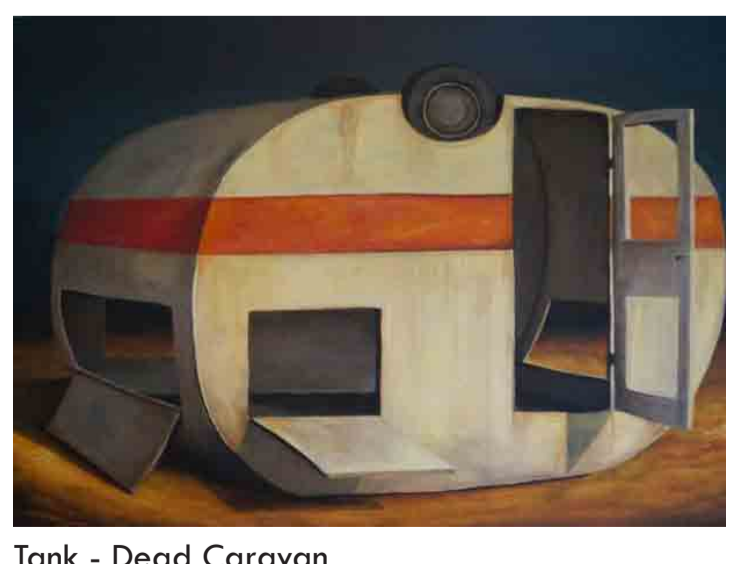

Tank - Dead Caravan



Project: 1820\_Shepparton Railway Linkages  
 Sheet: LP09\_Public Art Concept Plan  
 Client: Greater Shepparton City Council  
 Scale: 1:4,000 at A1 | Designed by: CR & GC | June 2018  
 Revision: | Drawn by: GC | June 2018  
 © Liesl Malan Landscape Architects | ABN 39 133 179 212  
 This Document is copyright protected and may only be used for the purpose for which it was commissioned. Unauthorised use prohibited. All dimensions and levels to be checked on the project before commencing any works or shop drawings. Drawings not to be scaled.